



STATE OF VERMONT
AGENCY OF DEVELOPMENT AND COMMUNITY AFFAIRS

DIVISION FOR HISTORIC PRESERVATION
Preserving Vermont's historic, architectural and archeological resources

June 23, 1992

Hyde Park Board of Selectmen
Hyde Park Town Offices
Hyde Park, Vermont 05655

Dear Sirs:

The Division for Historic Preservation is increasing its efforts to communicate with Towns about actions that are being taken regarding local properties. This is to inform you that at their March 24, 1992, meeting, the State Advisory Council on Historic Preservation placed the entire Vermont Historic Sites and Structures Survey for the town of Hyde Park on the State Register of Historic Places. This survey was done in 1981, and a copy given to the Town Clerk for use by the Town Offices after its completion.

Enclosed is some information on the State Register of Historic Places. State agencies are required to take into account the impact of their projects on Register properties, as outlined in the Vermont Historic Preservation Act of 1975 as amended (22 V.S.A. chapter 14).

If you have questions on concerning the State Register or the Hyde Park survey, please feel free to contact me.

Sincerely,

A large, stylized handwritten signature in black ink, appearing to read "C.B. Johnson".

Curtis B. Johnson
Architectural Historian

cc: Lamoille County Regional Planning Commission

Enclosures

POOR QUALITY

ORIGINAL LIGHT

COUNTY LamoilleTOWN Hyde Park

NAME OF SITE	SITE NO.	NEGATIVE FILE NO.	N.R.
Hyde Park Historic District BOOK I+II	0805-1	81-A-159, 201-206	161,
Ten Bends BOOK III	0805-2	81-A-253	
Cobleigh-Renaud House	0805-3	81-A-253	
Hyde-Currie House	0805-4	81-A-253	
Noyes Homestead	0805-5	81-A-253	
Corkins-Minton House	0805-6	81-A-253	
Jabez Fitch House	0805-7	81-A-253	
Newland-Plante House	0805-8	81-A-253	
Whitney-McAllister House	0805-9	81-A-253	
Garfield District School	0805-10	81-A-253	
Campbell-Frohm House	0805-11	81-A-253	
Collius-Cloud House	0805-12	81-A-253	
Cobleigh-Heath House	0805-13	81-A-253	
Holbrook-Kelley House	0805-14	81-A-253	
Vaughn-Silverstein House	0805-15	81-A-253	
Hyde-Godin House	0805-16	81-A-253	
Bliss-Lamphere House	0805-17	81-A-253	
Adams-Larson House	0805-18	81-A-253	
Crowell-Mihill House	0805-19	81-A-253	
Perry-Spear House	0805-20	81-A-252	
Bullard-Parsons House	0805-21	81-A-252	
Rt. 100C Bridge over Gihon River	0805-22	81-A-252 85-A-169	
North Hyde Park Historic District	0805-23	81-A-251, 252	
Harrington-Savage House BOOK IV	0805-24	81-A-253	
Ferry-Aither House	0805-25	81-A-253	
North Hyde Park Bridge	0805-26	81-A-252 85-A-170	
Old North Hyde Park Covered Bridge (archae.)	0805-27	81-A-252	

COUNTY Lamoille

TOWN Hyde Park

[illegible]

POOR QUALITY
ORIGINAL_____

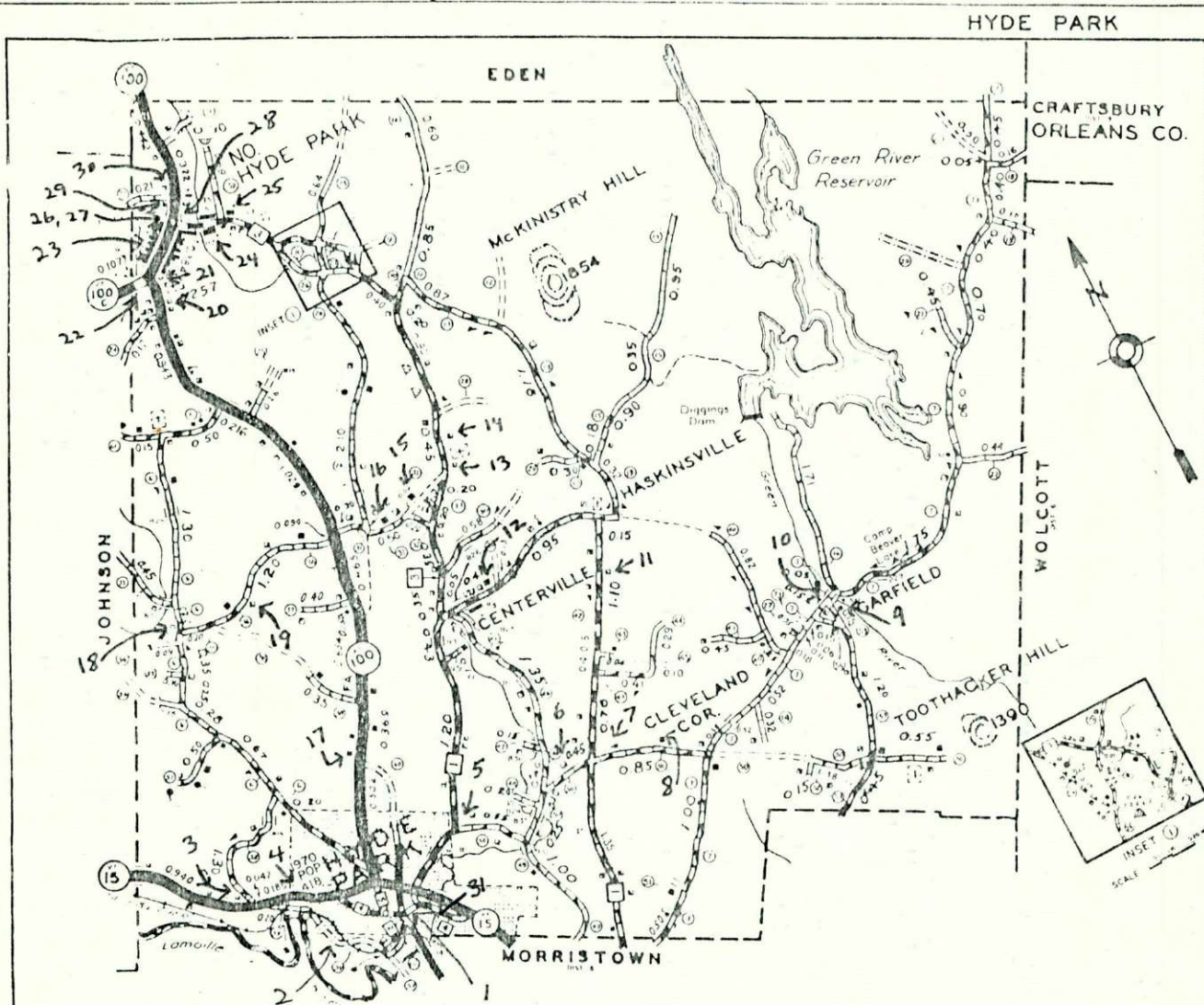

	U.S. NUMBERED ROUTE		PAVED ROAD	
	STATE HIGHWAY		SURFACE TREATED ROAD	
	NUMBERED STATE AID HWY.		GRAVEL ROAD	
	STATE AID HWY. WITH SELECTED TOWN NO.		SOIL SURFACE (2nd CLASS GRAVEL)	
	FEDERAL AID HIGHWAY		GRADED & DRAINED ROAD	
	TOWN HIGHWAY		UNIMPROVED ROAD	
	FARM UNIT		PRIMITIVE ROAD	
	DWELLING (OTHER THAN FARM)		UNTRAVELED ROAD	
	SCHOOL		CHURCH	
	BUSINESS		SEASONAL DWELLING CEMETERY	
	VACANT CULTURAL FEATURES		TRAIL	
	SHOWN IN OUTLINE FORM.		PRIVATE ROAD	

BRIDGES
 || SPAN 6' THRU 20'
 -| SPAN OVER 20'
 BRIDGE NO. — ...
 1) COVERED

TOWN HIGHWAY	49 22	MILES
STATE AID HWY. NO. 1	7.35	
STATE AID HWY. NO. 2	0.28	"
STATE AID HWY. NO. 3	4.53	"
STATE AID HWY. NO. 4	1.20	"
STATE AID HWY. NO. 5	<u>0.29</u>	"
TOTAL STATE AID	13	
STATE HIGHWAY NO. 15		
STATE HIGHWAY NO. 100		
STATE HIGHWAY NO. 101		
TOTAL STATE HW		LA-5
TOTAL ALL SYSTEMS		

NOTE: THE MILEAGE SHOWN IN THIS STATEMENT IS ONE
MILE MORE THAN THE COMBINED MILEAGE SHOWN IN
THE MILEAGE STATEMENT FOR THE OTHER TOWNS
IN CANTON (DUE TO THE TOWN'S LOCATION ON THE
CANTON LINE).

VERMONT HIGHWAY DISTRICT NO. 8

REVISED:	1243	1343	1450	164	154	174
	REV	REV	REV			

J491 J0 6-73
J491 J0 6-73 LAMOILLE COUNTY

Listed on State Register

VT ACHP

Date:

3-24-92

STATE OF VERMONT
Division for Historic Preservation
Montpelier, VT 05602

HISTORIC SITES & STRUCTURES SURVEY
Individual Structure Survey Form

COUNTY: Lamoille
TOWN: Hyde Park
LOCATION: Ferry Street, North
Hyde Park
COMMON NAME: Harrington-Savage House
FUNCTIONAL TYPE: Dwelling
OWNER: Thomas Savage
ADDRESS: North Hyde Park, Vermont
ACCESSIBILITY TO PUBLIC:
Yes ☐ No ☒ Restricted ☐
LEVEL OF SIGNIFICANCE:
Local ☐ State ☒ National ☐

GENERAL DESCRIPTION:

Structural System

1. Foundation: Stone ☒ Brick ☐ Concrete ☒ Concrete Block ☐
2. Wall Structure
 - a. Wood Frame: Post & Beam ☒ Balloon ☐
 - b. Load Bearing Masonry: Brick ☐ Stone ☐ Concrete ☐ Concrete Block ☐
 - c. Iron ☐ d. Steel ☐ e. Other:
3. Wall Covering: Clapboard ☒ Board & Batten ☐ Wood Shingle ☐ Shiplap ☐ Novelty ☐ Asbestos Shingle ☐ Sheet Metal ☐ Aluminum ☐ Asphalt Shingle ☐ Brick Veneer ☐ Stone Veneer ☐ Bonding Pattern: Other:
4. Roof Structure
 - a. Truss: Wood ☒ Iron ☐ Steel ☐ Concrete ☐
 - b. Other:
5. Roof Covering: Slate ☐ Wood Shingle ☐ Asphalt Shingle ☐ Sheet Metal ☒ Built Up ☐ Rolled ☐ Tile ☐ Other:
6. Engineering Structure:
7. Other:

Appendages: Porches ☒ Towers ☐ Cupolas ☐ Dormers ☐ Chimneys ☒ Sheds ☒ Ells ☐ Wings ☒ Bay Window ☐ Other:

Roof Style: Gable ☒ Hip ☐ Shed ☐ Flat ☐ Mansard ☐ Gambrel ☐ Jerkinhead ☐ Saw Tooth ☐ With Monitor ☐ With Bellcast ☐ With Parapet ☐ With False Front ☐ Other:

Number of Stories: 1½

Number of Bays: 3 x 2

Approximate Dimensions: 12' x 12'

SURVEY NUMBER: 0805-24

NEGATIVE FILE NUMBER:

81-A-253

UTM REFERENCES:

Zone/Easting/Northing

18/691,000/4,948,805

U.S.G.S. QUAD. MAP:

Hyde Park 1,62,500

PRESENT FORMAL NAME:

Thomas Savage House

ORIGINAL FORMAL NAME:

Ephraim Harrington House

PRESENT USE: Dwelling

ORIGINAL USE: Farmhouse

ARCHITECT/ENGINEER:

Unknown

BUILDER/CONTRACTOR:

Unknown

PHYSICAL CONDITION OF STRUCTURE:

Excellent ☐ Good ☒

Fair ☐ Poor ☐

STYLE: Greek Revival/Italianate

DATE BUILT:

c. 1870

THREAT TO STRUCTURE:

No Threat ☒ Zoning ☐ Roads ☐ Development ☐ Deterioration ☐ Alteration ☐ Other:

LOCAL ATTITUDES:

Positive ☐ Negative ☐ Mixed ☐ Other:

ADDITIONAL ARCHITECTURAL OR STRUCTURAL DESCRIPTION: 05/80 HDA IV Date: 07/80

A small square block with steeply-pitched gable roof, rear wing corner pilasters, and cornice returns on the front gable. Front door has round-arched panels, peaked cornice above. Sash is 2/2 with peaked window heads, window to right of door is new. Main block has tall chimney; wing has enclosed porch on east side; shed porch is in the rear.

RELATED STRUCTURES: (Describe)

1. A plain haybarn, 18' x 24', with gable roof and vertical board siding; entry on east side, built c. 1920
2. Small clapboard outbuilding with gable roof, built c. 1920

STATEMENT OF SIGNIFICANCE:

A small frame house with transitional Greek Revival/Italianate stylistic detail, including corner pilasters, cornice with returns, peaked window and door heads and round-arched panels on the front door. Built c. 1870, probably for Ephraim Harrington, a farmer, it stands substantially unaltered.

REFERENCES:

2, 3

MAP: (Indicate North in Circle)

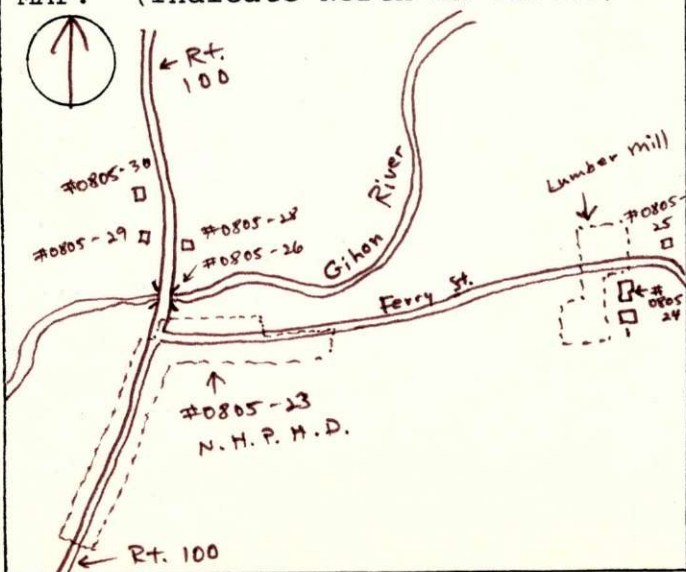

SURROUNDING ENVIRONMENT:

Open Land ☒ Woodland ☐
 Scattered Buildings ☐
 Moderately Built Up ☒
 Densely Built Up ☐
 Residential ☒ Commercial ☐
 Agricultural ☐ Industrial ☐
 Roadside Strip Development ☐
 Other:

RECORDED BY:
John C. Page

ORGANIZATION:
V. D. H. P.

DATE RECORDED:
August, 1981



81-253

Vt. Div. for Historic Preservation
Lamoille County Hyde Park 8/81
Harrington-Savage House, 0805-24 SW
81-A-253 John C. Page

Listed on State Register

VT ACHP

Date:

3-24-92

STATE OF VERMONT
Division for Historic Preservation
Montpelier, VT 05602

HISTORIC SITES & STRUCTURES SURVEY
Individual Structure Survey Form

COUNTY: Lamoille
TOWN: Hyde Park
LOCATION: end of Ferry Street,
North Hyde Park
COMMON NAME: Ferry-Aither House
FUNCTIONAL TYPE: dwelling
OWNER: Eric Aither
ADDRESS: North Hyde Park, Vermont
ACCESSIBILITY TO PUBLIC:
Yes ☐ No ☒ Restricted ☐
LEVEL OF SIGNIFICANCE:
Local ☐ State ☒ National ☐

GENERAL DESCRIPTION:

Structural System

1. Foundation: Stone ☒ Brick ☐ Concrete ☐ Concrete Block ☐
2. Wall Structure
 - a. Wood Frame: Post & Beam ☒ Balloon ☐
 - b. Load Bearing Masonry: Brick ☐ Stone ☐ Concrete ☐
Concrete Block ☐
 - c. Iron ☐ d. Steel ☐ e. Other:
3. Wall Covering: Clapboard ☒ Board & Batten ☐ Wood Shingle ☐
Shiplap ☐ Novelty ☐ Asbestos Shingle ☐ Sheet Metal ☐
Aluminum ☐ Asphalt Shingle ☐ Brick Veneer ☐ Stone Veneer ☐
Bonding Pattern: Other:
4. Roof Structure
 - a. Truss: Wood ☒ Iron ☐ Steel ☐ Concrete ☐
 - b. Other:
5. Roof Covering: Slate ☐ Wood Shingle ☐ Asphalt Shingle ☐
Sheet Metal ☒ Built Up ☐ Rolled ☐ Tile ☐ Other:
6. Engineering Structure:
7. Other:

Appendages: Porches ☒ Towers ☐ Cupolas ☐ Dormers ☐ Chimneys ☒
Sheds ☐ Ells ☒ Wings ☐ Bay Window ☐ Other:

Roof Style: Gable ☒ Hip ☐ Shed ☐ Flat ☐ Mansard ☐ Gambrel ☐
Jerkinhead ☐ Saw Tooth ☐ With Monitor ☐ With Bellcast ☐
With Parapet ☐ With False Front ☐ Other:

Number of Stories: $1\frac{1}{2}$

Number of Bays: 5 x 3

Approximate Dimensions: 25' x 20'

SURVEY NUMBER: 0805-25

NEGATIVE FILE NUMBER:

81-A-253

UTM REFERENCES:

Zone/Easting/Northing

18/691,145/4,948,750

U.S.G.S. QUAD. MAP:

Hyde Park 1:62,500

PRESENT FORMAL NAME:

Eric Aither House

ORIGINAL FORMAL NAME:

Joseph Ferry House

PRESENT USE: Family Residence

ORIGINAL USE: Farmhouse

ARCHITECT/ENGINEER:

Unknown

BUILDER/CONTRACTOR:

Joseph Ferry

PHYSICAL CONDITION OF STRUCTURE:

Excellent ☐ Good ☒Fair ☐ Poor ☐

STYLE: Classic Cottage

DATE BUILT:

c. 1835

THREAT TO STRUCTURE:

No Threat ☒ Zoning ☐ Roads ☐
Development ☐ Deterioration ☐
Alteration ☐ Other:

LOCAL ATTITUDES:

Positive ☐ Negative ☐
Mixed ☐ Other:

ADDITIONAL ARCHITECTURAL OR STRUCTURAL DESCRIPTION: Listed on 2/22/81
NHCA TV

Classic Cottage with new clapboard siding, shed-roofed veranda across south and west facades, inside-end chimney

Sash is 2/2 and 6/6

Entrance has panelled door and cantelevered 1/2 sidelight.

Porch is 4 x 4 bays, original chamfered posts on side, newer Square posts in front.

Ell adjoined to northwest corner has original clapboards and 6/6 sash on narrow south wall, new vertical board siding, and windows elsewhere.

RELATED STRUCTURES: (Describe)

STATEMENT OF SIGNIFICANCE:

A Classic Cottage situated on the far eastern edge of North Hyde Park Village. The low-pitched roof with eaves set flash to first-story lintels suggests an early, perhaps c. 1835, construction date. Sometime after the Civil War, a veranda with chamfered posts was added to the south and west walls. Clapboards are new. The house was probably built by Joseph Ferry, who built the first sawmill in North Hyde Park. His descendents, who were chiefly carpenters and joiners, occupied the house in 1859 and 1878.

REFERENCES: 1, 2, 3, 4

MAP: (Indicate North in Circle)

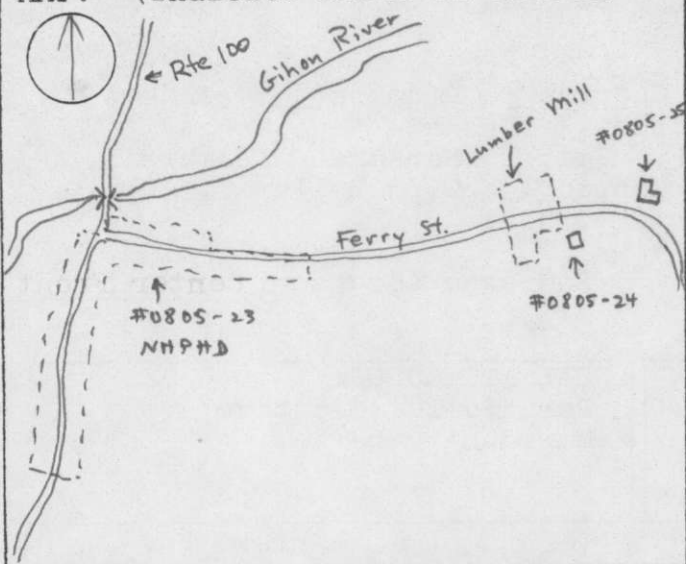

SURROUNDING ENVIRONMENT:

Open Land ☒ Woodland ☒
 Scattered Buildings ☐
 Moderately Built Up ☒
 Densely Built Up ☐
 Residential ☒ Commercial ☐
 Agricultural ☐ Industrial ☐
 Roadside Strip Development ☐
 Other:

RECORDED BY:

John C. Page

ORGANIZATION:

V. D. H. P.

DATE RECORDED:

August, 1981



81-253

Vt. Div. for Historic Preservation
Lamoille County Hyde Park 8/81
Ferry-Aither House, 0805-25 N
81-A-253 John C. Page

Listed on State Register
VT ACHP
Date: 3-24-92

LA 13 + Bridge Survey
12-13-90

STATE OF VERMONT
Division for Historic Preservation
Montpelier, VT 05602

HISTORIC SITES & STRUCTURES SURVEY
Bridge Survey Inventory Form

LOCATION:

Route 100

STREET, ROUTE or TOWN HIGHWAY

Gihon River

FEATURE CROSSED

County: Lamoille

Town: Hyde Park

Village: North Hyde Park

COMMON NAME:

OWNER: State of Vermont

ADDRESS: Agency of Transportation
Montpelier, Vermont 05602

SURVEY NUMBER: 0805-26
FIELD SITE NUMBER: LA-13
Negative File Number: 85-A-170

UTM REFERENCES:

Zone/Easting/Northing
18/690325/4949050

U.S.G.S. QUAD. MAP:

Hyde Park 15'

AOT Bridge Number (BCN):

00290217

Still in Use? Yes ☒ No ☐

Original Use: Highway ☒ Railroad ☐
Other ☐

Designer:

Fabricator: Berlin Construction Co.

Contractor: C.F. Newton

MATERIAL/DESIGN/Form:

Steel/Warren/Pony Truss
(ex.: Steel/Warren/Through Truss)

DATE:

1928

GENERAL DESCRIPTION

Construction Details

Metal Trusses: Pinned Connections ☐ Riveted ☒ Bolted ☐ Other ☐

Masonry arches: Ashlar ☐ Rubble ☐ Rubble w/ cut ring stones ☐ Other ☐
Type of Stone: _____

Concrete arches:

Other Features: Builder's Plate ☒ Other Date ☐ Portal Ornament ☐ Railing ☒
Sidewalks ☒ Inclined End Panels ☒ Segmental Top Chord ☐ Skewed ☐ Other ☐

Abutments: Ashlar ☐ Rubble ☐ Poured Concrete ☒ Other ☒ Sheet piling, S. only

Alterations: Structural Reinforcement ☒ New Deck ☐ Repointing ☐ Relocated ☐
Replaced Railing ☐ Other ☐

DIMENSIONS

Number of Spans: 1

Overall Length: 85

SPAN #	LENGTH	# PANELS	WIDTH	HEIGHT OVER FEATURE CROSSED	DEPTH of TRUSS	PORTAL CLEARANCE
1	80	6	21.1	9	c.12	N/A

SURROUNDING ENVIRONMENT: Open Land ☐ Woodland ☐ "Road-side Strip" Development ☐

Scattered Buildings ☐ Moderately Built-up ☒ Densely Built-up ☐

Residential ☒ Commercial ☐ Agricultural ☒ Industrial ☐ Other ☐

Related Features:

ADDITIONAL DESCRIPTION:

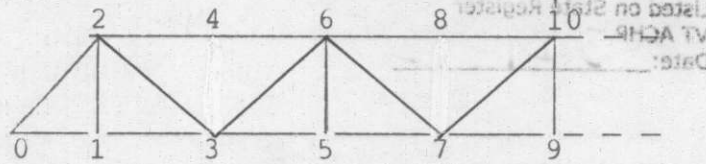

Top chord: Box girder with latticed underside, 15x10".
 Bottom chord: Two channels with top and bottom stay plates at 4' intervals.
 Verticals and diagonals: Rolled I-beams with new patch plates welded in the webs.
 Floor System: I-section floor beams and stringers, concrete-slab floor; sidewalk on new, welded-construction outriggers.
 Rail: Roadway: built up of angles and channels bolted to trusses.
 Sidewalk: Steel pipe on square steel balusters.

STATEMENT OF SIGNIFICANCE:

This bridge is significant as a representative example of the bridges built as a result of the 1927 flood, a major episode in Vermont's 20th-century history which resulted in an engineering effort of heroic proportions. The bridge uses the standardized design and economical construction which characterized the state's efforts to re-build a large number of bridges as quickly as possible. Pony Warren or Pratt trusses were used for most spans less than around 110' in length. Typically for the bridges of the post-flood era, rolled I-beams were used throughout, thus saving fabrication time and expense.

Berlin Construction Company was one of two principal suppliers of Vermont bridges in the post-flood era. C.F. Newton was one of several firms that received from Berlin subcontractors for erection.

REFERENCES:

Vermont Highway Commission, Biennial Report, 1928, table facing, p. 60.

SKETCH MAP (Indicate North in Circle)

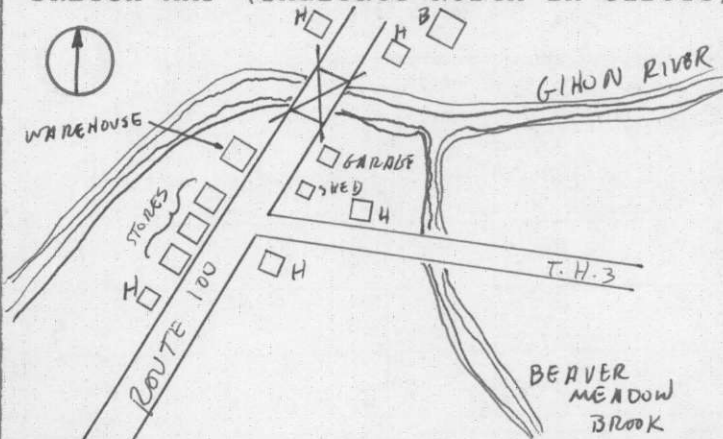

Plate Information:

Built by
 the
 Berlin Cons. Co.
 Berlin Conn
 1928

C.F. Newton Cons. Co.
 general cont.
 Springfield Mass

RECORDED BY:
 Matt Roth

ORGANIZATION:
 Historic Resource Consultants

DATE RECORDED:
 5/31/85

STATE OF VERMONT
Division for Historic Preservation
Montpelier, VT 05602

HISTORIC SITES & STRUCTURES SURVEY
Individual Structure Survey Form

COUNTY: Lamoille
TOWN: Hyde Park
LOCATION: Rt. 100 in North Hyde Park
COMMON NAME: North Hyde Park Bridge
FUNCTIONAL TYPE: bridge
OWNER:
ADDRESS:
ACCESSIBILITY TO PUBLIC:
Yes ☒ No ☐ Restricted ☐
LEVEL OF SIGNIFICANCE:
Local ☐ State ☒ National ☐

GENERAL DESCRIPTION:

Structural System

1. Foundation: Stone ☐ Brick ☐ Concrete ☐ Concrete Block ☐
2. Wall Structure
 - a. Wood Frame: Post & Beam ☐ Balloon ☐
 - b. Load Bearing Masonry: Brick ☐ Stone ☐ Concrete ☐ Concrete Block ☐
 - c. Iron ☐ d. Steel ☐ e. Other:
3. Wall Covering: Clapboard ☐ Board & Batten ☐ Wood Shingle ☐ Shiplap ☐ Novelty ☐ Asbestos Shingle ☐ Sheet Metal ☐ Aluminum ☐ Asphalt Shingle ☐ Brick Veneer ☐ Stone Veneer ☐ Bonding Pattern: Other:
4. Roof Structure
 - a. Truss: Wood ☐ Iron ☐ Steel ☐ Concrete ☐
 - b. Other:
5. Roof Covering: Slate ☐ Wood Shingle ☐ Asphalt Shingle ☐ Sheet Metal ☐ Built Up ☐ Rolled ☐ Tile ☐ Other:
6. Engineering Structure:
7. Other:

Appendages: Porches ☐ Towers ☐ Cupolas ☐ Dormers ☐ Chimneys ☐ Sheds ☐ Ells ☐ Wings ☐ Bay Window ☐ Other:

Roof Style: Gable ☐ Hip ☐ Shed ☐ Flat ☐ Mansard ☐ Gambrel ☐ Jerkinhead ☐ Saw Tooth ☐ With Monitor ☐ With Bellcast ☐ With Parapet ☐ With False Front ☐ Other:

Number of Stories: _____

Number of Bays: _____

Entrance Location: _____

Approximate Dimensions: _____

THREAT TO STRUCTURE:

No Threat ☒ Zoning ☐ Roads ☐
Development ☐ Deterioration ☐
Alteration ☐ Other:

SURVEY NUMBER: 0805-26

NEGATIVE FILE NUMBER: 81-A-252

UTM REFERENCES:

Zone/Easting/Northing
18/ 690,380/ 4,949,085

U.S.G.S. QUAD. MAP:

Hyde Park, Vt. 1:62,500

PRESENT FORMAL NAME:

ORIGINAL FORMAL NAME:

PRESENT USE: bridge

ORIGINAL USE: bridge

ARCHITECT/ENGINEER:

Berlin Construction Co.

BUILDER/CONTRACTOR:

G.F. Newton Construction Co.

PHYSICAL CONDITION OF STRUCTURE:

Excellent ☐ Good ☒
Fair ☐ Poor ☐

STYLE: Pratt pony truss

DATE BUILT: 1928

LOCAL ATTITUDES:

Positive ☒ Negative ☐
Mixed ☐ Other:

ADDITIONAL ARCHITECTURAL OR STRUCTURAL DESCRIPTION:

Waven
A ~~Pratt~~ pony truss steel bridge with a bearing-to-bearing span of approximately 70 feet. Tablets on both sides read: "G. F. Newton Construction Co., Springfield, Mass., General Contractors. Built by the Berlin Construction Co., Berlin, Mass., 1928."

RELATED STRUCTURES: (Describe)

STATEMENT OF SIGNIFICANCE:

A steel pony truss bridge which replaced a wooden covered bridge (see #0805-27) destroyed in the Flood of 1927. It is identical to #0805-22 except for a flat top chord and a slightly shorter span. Both were built by the same firms at the same time.

REFERENCES:

MAP: (Indicate North in Circle)

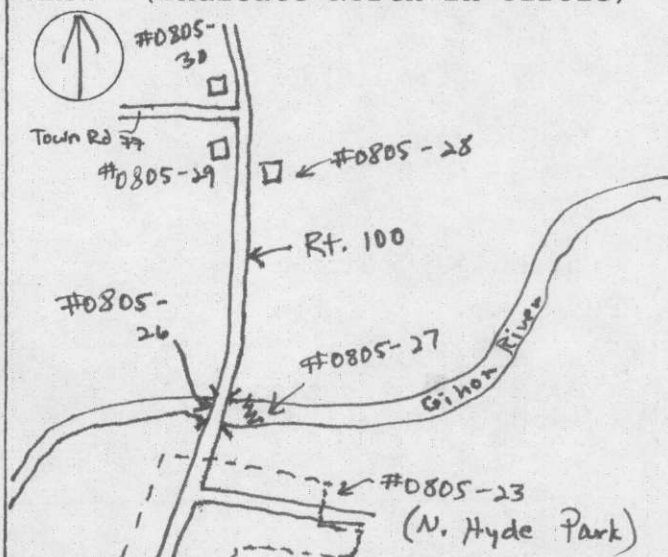

SURROUNDING ENVIRONMENT:

Open Land ☒ Woodland ☐
Scattered Buildings ☐
Moderately Built Up ☒
Densely Built Up ☐
Residential ☒ Commercial ☐
Agricultural ☐ Industrial ☐
Roadside Strip Development ☐
Other:

RECORDED BY: John C. Page

ORGANIZATION: V.D.H.P.

DATE RECORDED: August, 1981



85 A 170

Bridge Field No. LA-13
Hyde Park, Lamoille County, VT
Survey Number: 0805-26
Credit: HRC Date: 5/31/85

Side view, view SW

File Number: 85-A-170 Frame Number: 7 A



81-252

Vt. Div. for Historic Preservation
Lamoille County Hyde Park 8/81
North Hyde Park Bridge, 0805-26 NW
81-A-252 John C. Page

Listed on State Register

VT ACHP

Date:

3-24-92

STATE OF VERMONT
Division for Historic Preservation
Montpelier, VT 05602

HISTORIC SITES & STRUCTURES SURVEY
Individual Structure Survey Form

COUNTY: Lamoille
TOWN: Hyde Park
LOCATION: In Gihon River, just east
of North Hyde Park Bridge
COMMON NAME: Old North Hyde Park
Covered Bridge
FUNCTIONAL TYPE: archaeological site
OWNER:
ADDRESS:

ACCESSIBILITY TO PUBLIC:
Yes ☒ No ☐ Restricted ☐

LEVEL OF SIGNIFICANCE:
Local ☐ State ☒ National ☐

GENERAL DESCRIPTION:

Structural System

1. Foundation: Stone ☐ Brick ☐ Concrete ☐ Concrete Block ☐
2. Wall Structure
 - a. Wood Frame: Post & Beam ☐ Balloon ☐
 - b. Load Bearing Masonry: Brick ☐ Stone ☐ Concrete ☐ Concrete Block ☐
 - c. Iron ☐ d. Steel ☐ e. Other:
3. Wall Covering: Clapboard ☐ Board & Batten ☐ Wood Shingle ☐ Shiplap ☐ Novelty ☐ Asbestos Shingle ☐ Sheet Metal ☐ Aluminum ☐ Asphalt Shingle ☐ Brick Veneer ☐ Stone Veneer ☐ Bonding Pattern: Other:
4. Roof Structure
 - a. Truss: Wood ☐ Iron ☐ Steel ☐ Concrete ☐
 - b. Other:
5. Roof Covering: Slate ☐ Wood Shingle ☐ Asphalt Shingle ☐ Sheet Metal ☐ Built Up ☐ Rolled ☐ Tile ☐ Other:
6. Engineering Structure:
7. Other:

Appendages: Porches ☐ Towers ☐ Cupolas ☐ Dormers ☐ Chimneys ☐ Sheds ☐ Ells ☐ Wings ☐ Bay Window ☐ Other:

Roof Style: Gable ☐ Hip ☐ Shed ☐ Flat ☐ Mansard ☐ Gambrel ☐ Jerkinhead ☐ Saw Tooth ☐ With Monitor ☐ With Bellcast ☐ With Parapet ☐ With False Front ☐ Other:

Number of Stories: _____

Number of Bays: _____

Approximate Dimensions: _____

SURVEY NUMBER: 0805-27

NEGATIVE FILE NUMBER:
81-A-252UTM REFERENCES:
Zone/Easting/Northing
18/ 690,395/ 4,949,085U.S.G.S. QUAD. MAP:
Hyde Park, Vt. 1:62,500
PRESENT FORMAL NAME:ORIGINAL FORMAL NAME:
North Hyde Park Covered BridgePRESENT USE:
ORIGINAL USE: bridge trestlework
ARCHITECT/ENGINEER: unknown

BUILDER/CONTRACTOR: unknown

PHYSICAL CONDITION OF STRUCTURE:
Excellent ☐ Good ☐
Fair ☐ Poor ☒

STYLE:

DATE BUILT: c.1860

THREAT TO STRUCTURE:

No Threat ☐ Zoning ☐ Roads ☐
Development ☐ Deterioration ☐
Alteration ☐ Other:

LOCAL ATTITUDES:

Positive ☐ Negative ☐
Mixed ☐ Other:

ADDITIONAL ARCHITECTURAL OR STRUCTURAL DESCRIPTION:

A bridge trestlework constructed of layers of 8"x8" beams, mostly squared, but some round logs on the lower levels with notches to accept beams. The beams appear to be joined by long iron spikes. On the top surface are two lanes of board roadways. Large concrete piers on the river bank are broken and washed out.

RELATED STRUCTURES: (Describe)

STATEMENT OF SIGNIFICANCE:

Located just east (upriver) from the present North Hyde Park Bridge (#0805-26), this site is the remains of the covered bridge which spanned the Gihon River from the Civil War until 1927, when it was destroyed by the great flood. The unusual trestlwork appears to have been built on the river bed itself, secured at the banks and on a small island in the middle, or perhaps on top of a dam which created a small millpond to the east.

REFERENCES:

3

MAP: (Indicate North in Circle)

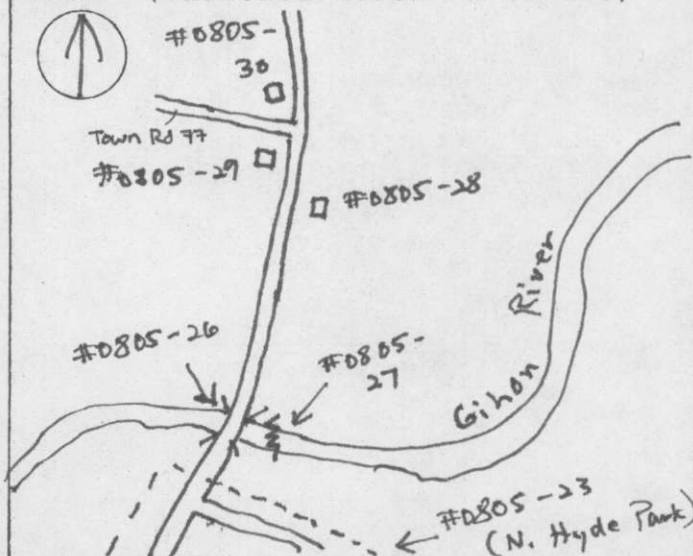

SURROUNDING ENVIRONMENT:

Open Land ☒ Woodland ☐
 Scattered Buildings ☐
 Moderately Built Up ☒
 Densely Built Up ☐
 Residential ☒ Commercial ☐
 Agricultural ☐ Industrial ☐
 Roadside Strip Development ☐
 Other:

RECORDED BY: John C. Page

ORGANIZATION: V.D.H.P.

DATE RECORDED: August, 1981



81-252

Vt. Div. for Historic Preservation
Lamoille County Hyde Park 8/81
Covered Bridge Trestle, 0805-27 N
81-A-252 John C. Page

Listed on State Register

VT ACHP

Date:

3-24-92

STATE OF VERMONT
Division for Historic Preservation
Montpelier, VT 05602

HISTORIC SITES & STRUCTURES SURVEY
Individual Structure Survey Form

SURVEY NUMBER: 0805-28

NEGATIVE FILE NUMBER:

81-A-252

UTM REFERENCES:

Zone/Easting/Northing
18/690,480/4,949,190

U.S.G.S. QUAD. MAP:

Hyde Park 1:62,500

PRESENT FORMAL NAME:

Ken Wolf House

ORIGINAL FORMAL NAME:

George Hooper House

PRESENT USE: Family Residence

ORIGINAL USE: Farmhouse

ARCHITECT/ENGINEER:

Unknown

BUILDER/CONTRACTOR:

Unknown

PHYSICAL CONDITION OF STRUCTURE:

Excellent ☐ Good ☒
Fair ☐ Poor ☐

STYLE: Classic Cottage

DATE BUILT: c. 1865

COUNTY: Lamoille

TOWN: Hyde Park

LOCATION: Rt. 100, just north of
North Hyde Park

COMMON NAME: Hooper-Wolf House

FUNCTIONAL TYPE: Dwelling

OWNER: Kenneth Wolf

ADDRESS: North Hyde Park, Vermont

ACCESSIBILITY TO PUBLIC:

Yes ☐ No ☒ Restricted ☐

LEVEL OF SIGNIFICANCE:

Local ☐ State ☒ National ☐

GENERAL DESCRIPTION:

Structural System

1. Foundation: Stone ☒ Brick ☐ Concrete ☒ Concrete Block ☐

2. Wall Structure

a. Wood Frame: Post & Beam ☒ Balloon ☐b. Load Bearing Masonry: Brick ☐ Stone ☐ Concrete ☐
Concrete Block ☐c. Iron ☐ d. Steel ☐ e. Other:3. Wall Covering: Clapboard ☒ Board & Batten ☐ Wood Shingle ☐Shiplap ☐ Novelty ☐ Asbestos Shingle ☐ Sheet Metal ☐Aluminum ☐ Asphalt Shingle ☐ Brick Veneer ☐ Stone Veneer ☐

Bonding Pattern: Other:

4. Roof Structure

a. Truss: Wood ☒ Iron ☐ Steel ☐ Concrete ☐

b. Other:

5. Roof Covering: Slate ☐ Wood Shingle ☐ Asphalt Shingle ☐Sheet Metal ☒ Built Up ☐ Rolled ☐ Tile ☐ Other:

6. Engineering Structure:

7. Other:

Appendages: Porches ☒ Towers ☐ Cupolas ☐ Dormers ☐ Chimneys ☒
Sheds ☐ Ells ☐ Wings ☐ Bay Window ☐ Other:Roof Style: Gable ☒ Hip ☐ Shed ☐ Flat ☐ Mansard ☐ Gambrel ☐Jerkinhead ☐ Saw Tooth ☐ With Monitor ☐ With Bellcast ☐With Parapet ☐ With False Front ☐ Other:

Number of Stories: 1½

Number of Bays: 5 x 2

Entrance Location: Center Front

Approximate Dimensions: 30' x 15'

THREAT TO STRUCTURE:

No Threat ☐ Zoning ☐ Roads ☐
Development ☐ Deterioration ☐
Alteration ☐ Other:

LOCAL ATTITUDES:

Positive ☐ Negative ☐
Mixed ☐ Other:

ADDITIONAL ARCHITECTURAL OR STRUCTURAL DESCRIPTION:

Classic Cottage with inside-end chimneys, molded cornice, gable returns, frieze boards, 2/2 sash, replacement door; porch in the rear has chamfered posts.

Adjoined to the northeast corner is a L-plan stable with gable roof and clapboard siding; 9/6 sash on front (west) facade, fixed windows elsewhere; entries are on the south side at rear of house.

RELATED STRUCTURES: (Describe)

STATEMENT OF SIGNIFICANCE:

A Classic Cottage with little style but in an unaltered condition. It was built c. 1865, probably for George Hooper, a farmer, and typifies the modest but comfortable housing of the bulk of middle class Vermont farm families.

REFERENCES: 2, 3

MAP: (Indicate North in Circle)

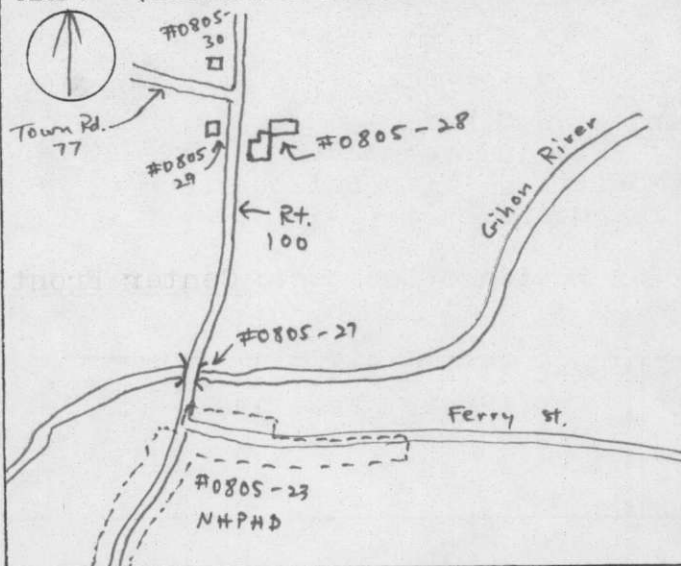

SURROUNDING ENVIRONMENT:

Open Land ☒ Woodland ☐
 Scattered Buildings ☐
 Moderately Built Up ☒
 Densely Built Up ☐
 Residential ☒ Commercial ☐
 Agricultural ☒ Industrial ☐
 Roadside Strip Development ☐
 Other:

RECORDED BY:

John C. Page

ORGANIZATION:

V. D. H. P.

DATE RECORDED:

August, 1981



81-252

Vt. Div. for Historic Preservation
Lamoille County Hyde Park 8/81
Hooper-Wolf House, 0805-28 E
81-A-252 John C. Page

Listed on State Register

VT ACHP

Date:

3-24-92

STATE OF VERMONT
Division for Historic Preservation
Montpelier, VT 05602

HISTORIC SITES & STRUCTURES SURVEY
Individual Structure Survey Form

COUNTY: Lamoille
TOWN: Hyde Park
LOCATION: Rt. 100, corner of town
Rd. # 77, just north of North
Hyde Park
COMMON NAME: Ward-Crocker House
FUNCTIONAL TYPE: Dwelling
OWNER: Phil Ward
ADDRESS: North Hyde Park, Vermont
ACCESSIBILITY TO PUBLIC:
Yes ☐ No ☒ Restricted ☐
LEVEL OF SIGNIFICANCE:
Local ☐ State ☒ National ☐

GENERAL DESCRIPTION:

Structural System

1. Foundation: Stone ☒ Brick ☐ Concrete ☐ Concrete Block ☐

2. Wall Structure

a. Wood Frame: Post & Beam ☒ Balloon ☐b. Load Bearing Masonry: Brick ☐ Stone ☐ Concrete ☐
Concrete Block ☐c. Iron ☐ d. Steel ☐ e. Other:3. Wall Covering: Clapboard ☒ Board & Batten ☐ Wood Shingle ☐Shiplap ☐ Novelty ☐ Asbestos Shingle ☐ Sheet Metal ☐Aluminum ☐ Asphalt Shingle ☐ Brick Veneer ☐ Stone Veneer ☐

Bonding Pattern: Other:

4. Roof Structure

a. Truss: Wood ☒ Iron ☐ Steel ☐ Concrete ☐

b. Other:

5. Roof Covering: Slate ☐ Wood Shingle ☐ Asphalt Shingle ☐Sheet Metal ☒ Built Up ☐ Rolled ☐ Tile ☐ Other:

6. Engineering Structure:

7. Other:

Appendages: Porches ☒ Towers ☐ Cupolas ☐ Dormers ☐ Chimneys ☒
Sheds ☐ Ells ☐ Wings ☒ Bay Window ☐ Other:Roof Style: Gable ☒ Hip ☐ Shed ☐ Flat ☐ Mansard ☐ Gambrel ☐Jerkinhead ☐ Saw Tooth ☐ With Monitor ☐ With Bellcast ☐With Parapet ☐ With False Front ☐ Other:

Number of Stories: 1½

Number of Bays: 3 x 2

Approximate Dimensions: 30' x 20'

SURVEY NUMBER: 0805-29

NEGATIVE FILE NUMBER:

81-A-252

UTM REFERENCES:

Zone/Easting/Northing

18/690,455/4,949,255

U.S.G.S. QUAD. MAP:

Hyde Park 1:62,500

PRESENT FORMAL NAME:

Ward House

ORIGINAL FORMAL NAME:

James Crocker House

PRESENT USE: Family Residence

ORIGINAL USE: Farmhouse

ARCHITECT/ENGINEER:

Unknown

BUILDER/CONTRACTOR:

Edward Bullard ?

PHYSICAL CONDITION OF STRUCTURE:

Excellent ☐ Good ☒Fair ☐ Poor ☐

STYLE: Classic Cottage

DATE BUILT:

c. 1869

THREAT TO STRUCTURE:

No Threat ☐ Zoning ☐ Roads ☐Development ☐ Deterioration ☐Alteration ☐ Other:

LOCAL ATTITUDES:

Positive ☐ Negative ☐Mixed ☐ Other:

ADDITIONAL ARCHITECTURAL OR STRUCTURAL DESCRIPTION:

Classic Cottage with molded cornice, gable returns, and ornate Italianate-style bay windows flanking a matching front entrance porch; long south wing.

Front entrance has panelled door, sidelights, and pilasters enriched with fretwork. The pedimented porch has square columns on pedestal with scroll-cut brackets at the caps; turned balustrades; pediment has denticulated friezes, scroll enrichment on tympanum.

Bay windows have bracketed cornices with denticulated and scroll-motif friezes; other windows have 2/2 sash.

South wing has 2-bay shed porch on chamfered posts, large bay opening.

RELATED STRUCTURES: (Describe)

STATEMENT OF SIGNIFICANCE:

This Classic Cottage is significant because of its ornate front entrance porch and flanking bay windows. The style is essentially Italianate, but suggests, in a vernacular form, the opulence of the Eastlake and other contemporary high-Victorian motifs. The house was built in the late 1860's or early 1870's for James Crocker, a farmer, perhaps by Edwin Bullard, a local builder believed responsible for the Bullard-Burnham House (NHPHD # 12), and other highly picturesque houses in the area. The porch is identical to the one on the Lilley-Potter House (# 0805-1-94).

REFERENCES: 2, 3, 4

MAP: (Indicate North in Circle)

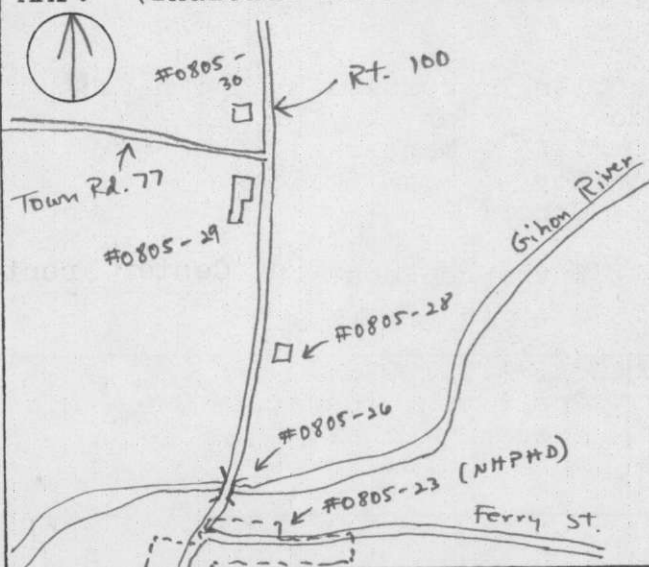

SURROUNDING ENVIRONMENT:

Open Land ☒ Woodland ☐
Scattered Buildings ☐
Moderately Built Up ☒
Densely Built Up ☐
Residential ☒ Commercial ☐
Agricultural ☒ Industrial ☐
Roadside Strip Development ☐
Other:

RECORDED BY:

John C. Page

ORGANIZATION:

V. D. H. P.

DATE RECORDED:

August, 1981



81-252

Vt. Div. for Historic Preservation
Lamoille County Hyde Park 8/81
Ward-Crocker House, 0805-29 W
81-A-252 John C. Page

Listed on State Register

VT ACHP

Date:

3-24-92

STATE OF VERMONT
Division for Historic Preservation
Montpelier, VT 05602

HISTORIC SITES & STRUCTURES SURVEY
Individual Structure Survey Form

COUNTY: Lamoille
TOWN: Hyde Park
LOCATION: on Rt. 100, north edge
of North Hyde Park
COMMON NAME: Crocker-Mudgett
FUNCTIONAL TYPE: Dwelling
OWNER: Paul Mudgett
ADDRESS: North Hyde Park, Vermont
ACCESSIBILITY TO PUBLIC:
Yes ☐ No ☒ Restricted ☐
LEVEL OF SIGNIFICANCE:
Local ☐ State ☒ National ☐
GENERAL DESCRIPTION:

Structural System

1. Foundation: Stone ☒ Brick ☐ Concrete ☐ Concrete Block ☐
 2. Wall Structure
 - a. Wood Frame: Post & Beam ☒ Balloon ☐
 - b. Load Bearing Masonry: Brick ☐ Stone ☐ Concrete ☐ Concrete Block ☐
 - c. Iron ☐ d. Steel ☐ e. Other:
 3. Wall Covering: Clapboard ☒ Board & Batten ☐ Wood Shingle ☐ Shiplap ☐ Novelty ☐ Asbestos Shingle ☐ Sheet Metal ☐ Aluminum ☐ Asphalt Shingle ☐ Brick Veneer ☐ Stone Veneer ☐ Bonding Pattern: Other:
 4. Roof Structure
 - a. Truss: Wood ☒ Iron ☐ Steel ☐ Concrete ☐
 - b. Other:
 5. Roof Covering: Slate ☐ Wood Shingle ☐ Asphalt Shingle ☒ Sheet Metal ☐ Built Up ☐ Rolled ☐ Tile ☐ Other:
 6. Engineering Structure:
 7. Other:
- Appendages: Porches ☐ Towers ☐ Cupolas ☐ Dormers ☐ Chimneys ☒ Sheds ☒ Ells ☒ Wings ☐ Bay Window ☐ Other:
- Roof Style: Gable ☒ Hip ☐ Shed ☐ Flat ☐ Mansard ☐ Gambrel ☐ Jerkinhead ☐ Saw Tooth ☐ With Monitor ☐ With Bellcast ☐ With Parapet ☐ With False Front ☐ Other:

Number of Stories: 2 1/2Number of Bays: 5 x 3Approximate Dimensions: 30' x 20'

SURVEY NUMBER: 0805-30

NEGATIVE FILE NUMBER:

81-A-252

UTM REFERENCES:

Zone/Easting/Northing

18/690,490/4,949,345

U.S.G.S. QUAD. MAP:

Hyde Park 1:62,500

PRESENT FORMAL NAME:

Mudgett House

ORIGINAL FORMAL NAME:

Crocker's Hotel

PRESENT USE: Family Residence

ORIGINAL USE: Inn

ARCHITECT/ENGINEER:

Unknown

BUILDER/CONTRACTOR:

Unknown

PHYSICAL CONDITION OF STRUCTURE:

Excellent ☐ Good ☒Fair ☐ Poor ☐

STYLE: Greek Revival

DATE BUILT:

c. 1850

THREAT TO STRUCTURE:

No Threat ☒ Zoning ☐ Roads ☐
Development ☐ Deterioration ☐
Alteration ☐ Other:

LOCAL ATTITUDES:

Positive ☐ Negative ☐
Mixed ☐ Other:

ADDITIONAL ARCHITECTURAL OR STRUCTURAL DESCRIPTION:

T-plan has eaves-front main block and large rear ell.

Molded cornice; pedimented gables have paired 2/2 sash and fan louvres in peaks.

Central hall entrance has cross-and-bible panelled door; surround has pilasters with fretwork at the bases and caps supporting a full enablature.

Sash is 2/2; second story windows are flush to the cornice; bay window on east gable end. Short west wing with shed roof has cross-and-bible panelled door, connects the house to a 20' x 20' stable shingle siding, gable roof, large sliding door on south wall.

RELATED STRUCTURES: (Describe)

STATEMENT OF SIGNIFICANCE:

This large c. 1850 house is essentially Greek Revival in style, but with vestigial Federal-style features and an early Italianate-type bay window. Pedimented gables with fan louvres, classical entrance surround with Greek fretwork, and cross-and-bible panelled doors are the chief stylistic elements. The exterior fabric appears virtually unaltered.

The house may originally have been a farmhouse or family residence, but as early as 1857 it was an inn operated by James Crocker, and called Crocker's Hotel. In 1878, Mrs C. M. Crocker kept a store and post office here. This is one of the most architecturally signifacant buildings in Hyde Park, and perhaps the earliest public house in the north village.

REFERENCES:

1, 2, 3.

MAP: (Indicate North in Circle)

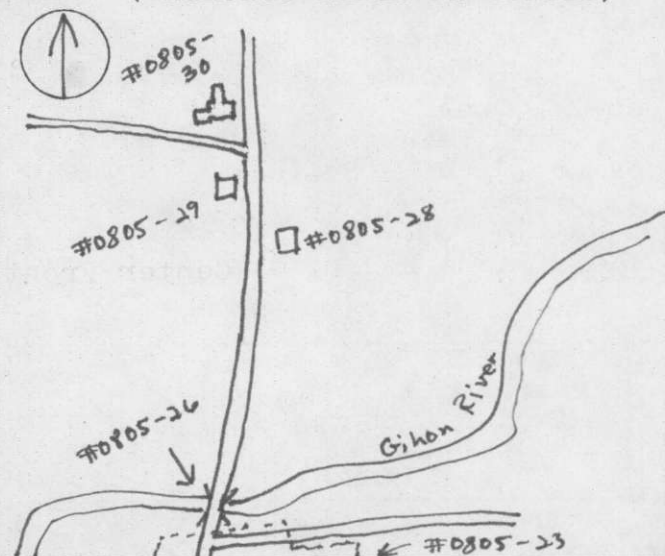

SURROUNDING ENVIRONMENT:

Open Land ☒ Woodland ☐
 Scattered Buildings ☐
 Moderately Built Up ☒
 Densely Built Up ☐
 Residential ☒ Commercial ☐
 Agricultural ☒ Industrial ☐
 Roadside Strip Development ☐
 Other:

RECORDED BY:

John C. Page

ORGANIZATION:

V. D. H. P.

DATE RECORDED:

August, 1981



81-252

Vt. Div. for Historic Preservation
Lamoille County Hyde Park 8/81
Crocker-Mudgett House, 0805-30 N
81-A-252 John C. Page

LA-11
4 Bridge Survey 12-13-90
Listed on State Register
VT ACHP
Date: 3-24-92

STATE OF VERMONT
Division for Historic Preservation
Montpelier, VT 05602

HISTORIC SITES & STRUCTURES SURVEY
Bridge Survey Inventory Form

SURVEY NUMBER: 0805-31
FIELD SITE NUMBER: LA-11
Negative File Number: 85-A-169

UTM REFERENCES:

Zone/Easting/Northing

18/689700/4940130

U.S.G.S. QUAD. MAP:

Hyde Park 15'

AOT Bridge Number (BCN):

08050041

Still in Use? Yes ☒ No ☐

Original Use: Highway ☒ Railroad ☐
Other ☐

Designer:

Fabricator:

Contractor:

MATERIAL/DESIGN/Form:

Concrete Arch
(ex.: Steel/Warren/Through Truss)

DATE:

1924

LOCATION:

T.H. 4

STREET, ROUTE or TOWN HIGHWAY

Centerville Brook

FEATURE CROSSED

County: Lamoille

Town: Hyde Park

Village: Hyde Park

COMMON NAME:

OWNER: Town of Hyde Park

ADDRESS: Hyde Park, VT 05655

GENERAL DESCRIPTION

Construction Details

Metal Trusses: Pinned Connections ☐ Riveted ☐ Bolted ☐ Other ☐

Masonry arches: Ashlar ☐ Rubble ☐ Rubble w/ cut ring stones ☐ Other ☐
Type of Stone: _____

Concrete arches:

Other Features: Builder's Plate ☐ Other Date ☐ Portal Ornament ☐ Railing ☐
Sidewalks ☐ Inclined End Panels ☐ Segmental Top Chord ☐ Skewed ☐ Other ☐

Abutments: Ashlar ☐ Rubble ☐ Poured Concrete ☐ Other ☐

Alterations: Structural Reinforcement ☐ New Deck ☐ Repointing ☐ Relocated ☐
Replaced Railing ☐ Other ☐

DIMENSIONS

Number of Spans: 1

Overall Length: 70

SPAN #	LENGTH	# PANELS	WIDTH	HEIGHT OVER FEATURE CROSSED	DEPTH of TRUSS	PORTAL CLEARANCE
1	65	N/A	23.4	30	N/A	N/A

SURROUNDING ENVIRONMENT: Open Land ☐ Woodland ☐ "Road-side Strip" Development ☐
Scattered Buildings ☐ Moderately Built-up ☒ Densely Built-up ☐
Residential ☒ Commercial ☐ Agricultural ☒ Industrial ☐ Other ☐

Related Features:

ADDITIONAL DESCRIPTION:

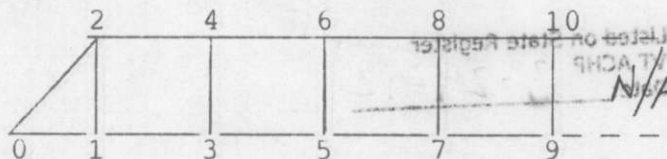

Solid barrel, solid spandrel, shallow concrete arch crossing between high outcropping of ledge to either side. Paneled parapets with plain coping; outside concrete string courses at the level of the roadway.

STATEMENT OF SIGNIFICANCE:

This bridge illustrates the growing popularity of concrete for simple crossings in the early 20th century. It gained favor in large part for its economic advantages. Concrete structures used locally available materials (sand and gravel), and required no specialized construction expertise beyond what was available in the local labor force. And unlike the design of even the simplest truss bridges of this period, concrete structures did not necessarily demand high-level engineering expertise. Indeed, the state Highway Commission offered such plans at no charge, starting in 1915. The bridge replaced a covered, timber lattice truss.

REFERENCES:

Vermont Highway Commission, Biennial Report, 1924, p. 9; photo of new bridge and the one it replaced.

SKETCH MAP (Indicate North in Circle)

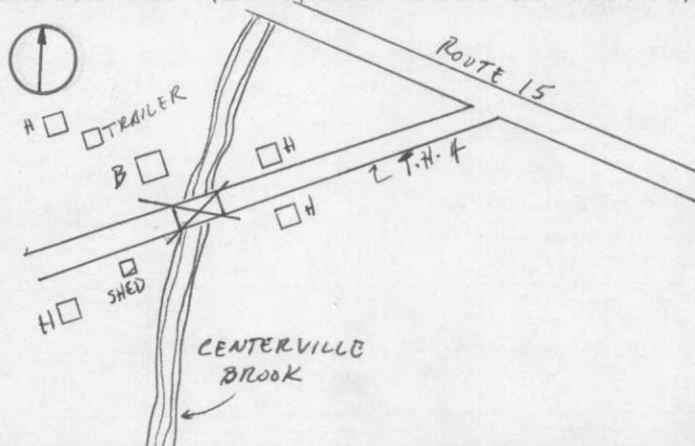
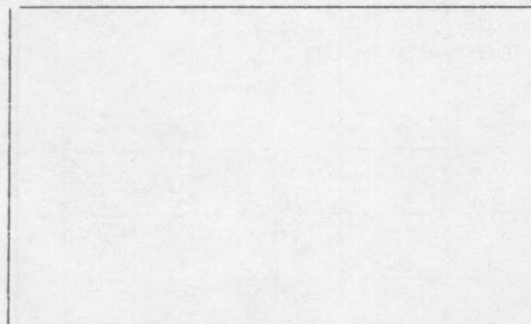

Plate Information:



RECORDED BY:

Matt Roth

ORGANIZATION:

Historic Resource Consultants

DATE RECORDED:

5/30/85



85A 169

Bridge Field No. LA-11
Hyde Park, Lamoille County, VT
Survey Number: 0805-31
Credit: HRC Date: 5/30/85

Side perspective view SW

File Number: 85-A-169 Frame Number: 20 A