

Hyde Park, Vermont

- Legend**
- Property Lines ————
 - Contour Index ————
 - Contour ————
 - Proposed Contour ————
 - Proposed Road Edge ————

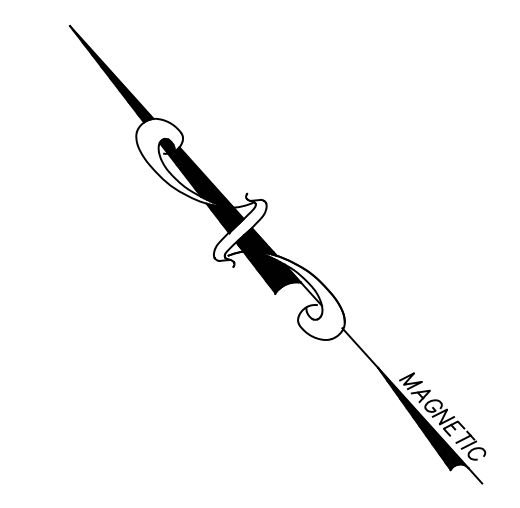

It is noted that no site assessment of hazardous or other waste materials has been performed and Summit Engineering, Inc. takes no responsibility for any materials or conditions which may exist on this site. Underground utilities shown are approximate only and were depicted from surface features located, referenced plans and information from the Town and Village.

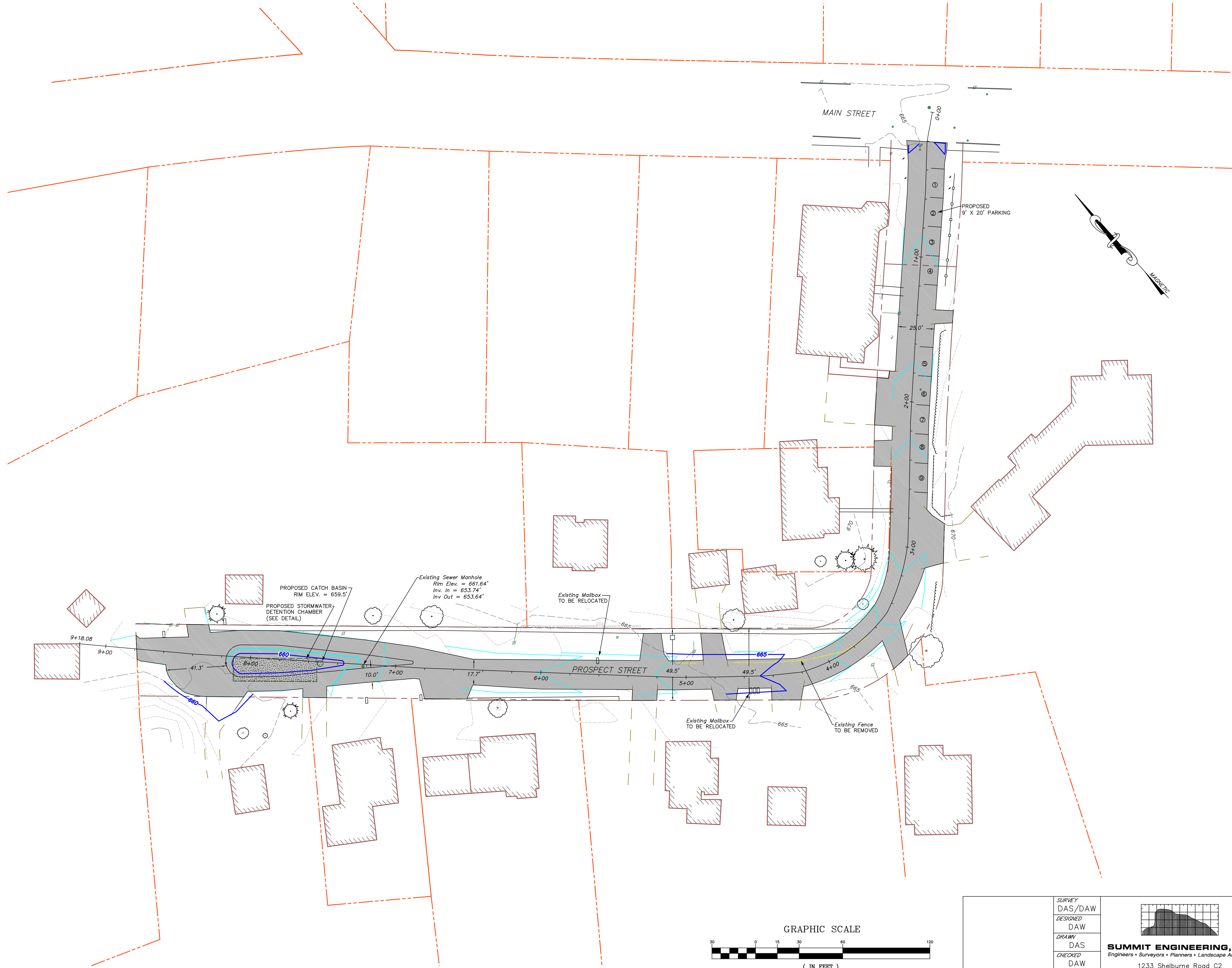
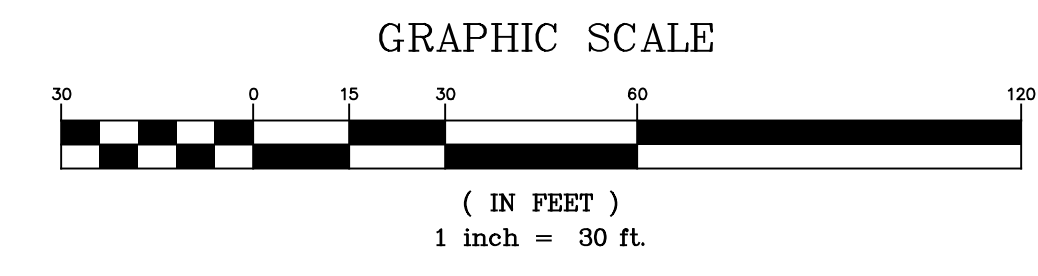

SURVEY	DAS/DAW
DESIGNED	DAW
DRAWN	DAS
CHECKED	DAW
SCALE	AS SHOWN

SUMMIT ENGINEERING, INC
 Engineers • Surveyors • Planners • Landscape Architects
 1233 Shelburne Road C2
 South Burlington, VT 05403
 (802) 658-5588

GRADING PLAN	DATE 9/9/21
PROSPECT STREET IMPROVEMENTS PROSPECT STREET HYDE PARK, VERMONT	DRAWING NO. S1
	PROJECT NO. 8432