

Hyde Park, Vermont

- Legend**
- Property Lines ————
  - Contour Index ————
  - Contour ————
  - Proposed Contour ————
  - Proposed Road Edge ————

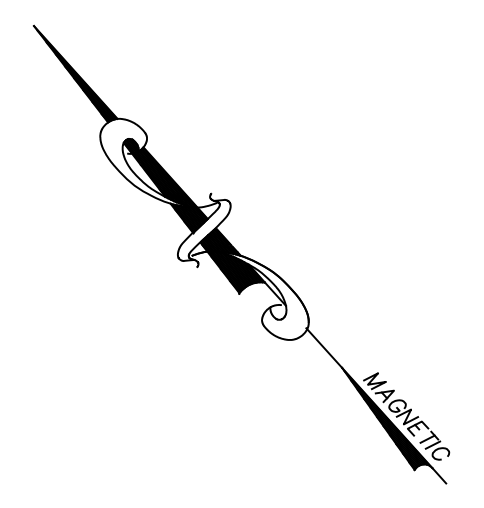

It is noted that no site assessment of hazardous or other waste materials has been performed and Summit Engineering, Inc. takes no responsibility for any materials or conditions which may exist on this site. Underground utilities shown are approximate only and were depicted from surface features located, referenced plans and information from the Town and Village.

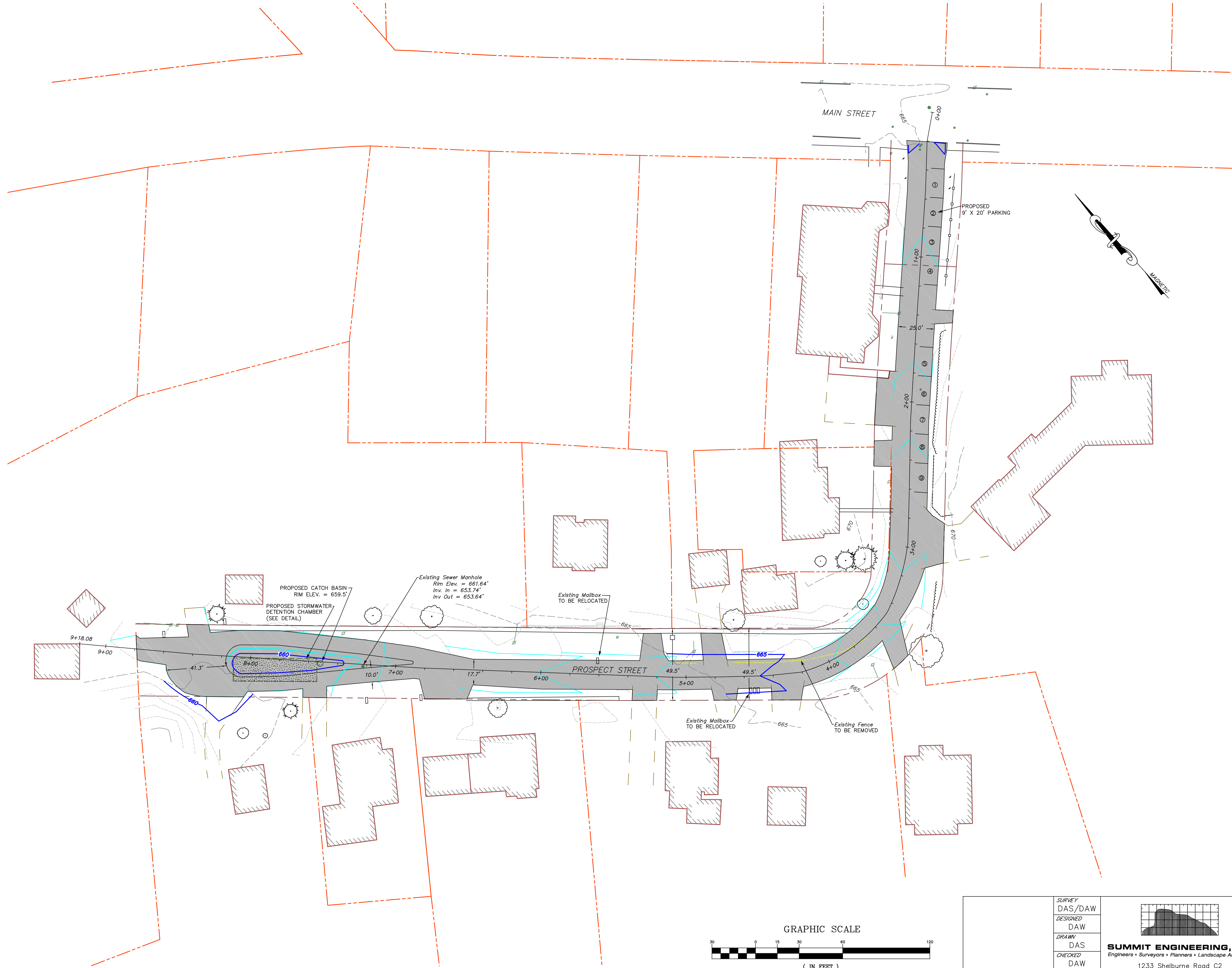
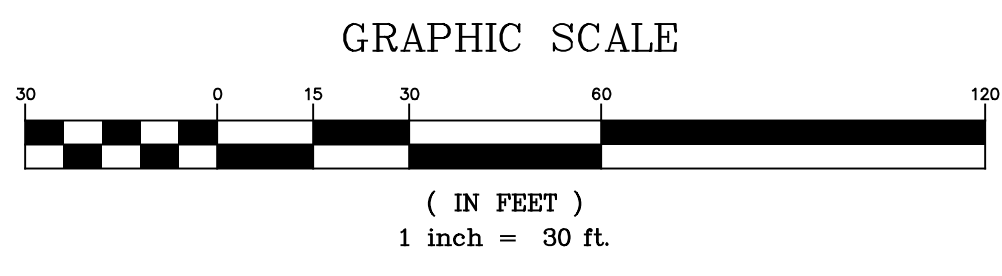

SURVEY DAS/DAW DESIGNED DAW DRAWN DAS CHECKED DAW SCALE AS SHOWN	 <b>SUMMIT ENGINEERING, INC</b> Engineers • Surveyors • Planners • Landscape Architects 1233 Shelburne Road C2 South Burlington, VT 05403 (802) 658-5588	GRADING PLAN	DATE 9/9/21
		PROSPECT STREET IMPROVEMENTS PROSPECT STREET HYDE PARK, VERMONT	DRAWING NO. S1 PROJECT NO. 8432